

Courtesy Of John Rota Of Sweetly

## \$585,000 - 70 Gladstone Bend, Spruce Grove

MLS® #E4427680

**\$585,000**

3 Bedroom, 2.50 Bathroom, 1,982 sqft  
Single Family on 0.00 Acres

Greenbury, Spruce Grove, AB

Discover this charming two-storey home in Greenbury, Spruce Grove. The main floor features a cozy living room with access to the deck, a dining room, a modern kitchen, a mudroom, and a convenient 2-piece bathroom.

Upstairs, you'll find a spacious bonus room, a primary bedroom with a walk-in closet and a luxurious 5-piece ensuite, two additional bedrooms, a laundry room, and a 4-piece bathroom. This home also includes an attached double garage, perfect for your parking and storage needs. This home combines comfort and functionality. A must see!

Built in 2025

### Essential Information

MLS® #	E4427680
Price	\$585,000
Bedrooms	3
Bathrooms	2.50
Full Baths	2
Half Baths	1
Square Footage	1,982
Acres	0.00
Year Built	2025
Type	Single Family
Sub-Type	Detached Single Family

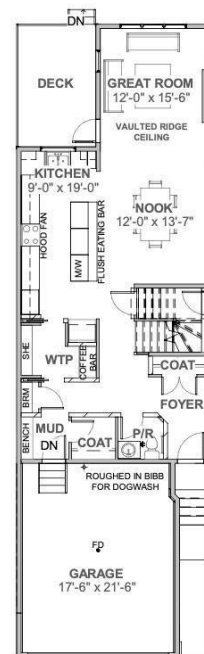

MAIN FLOOR PLAN  
9'-1" CEILING HEIGHT

Style	2 Storey
Status	Active

### Community Information

Address	70 Gladstone Bend
Area	Spruce Grove
Subdivision	Greenbury
City	Spruce Grove
County	ALBERTA
Province	AB
Postal Code	T7X 2X6

### Amenities

Amenities	Detectors Smoke, No Animal Home, No Smoking Home
Parking	Double Garage Attached

### Interior

Interior Features	ensuite bathroom
Appliances	See Remarks
Heating	Forced Air-1, Natural Gas
Stories	2
Has Basement	Yes
Basement	Full, Unfinished

### Exterior

Exterior	Wood, Vinyl
Exterior Features	Playground Nearby, Public Transportation, Schools, Shopping Nearby
Roof	Asphalt Shingles
Construction	Wood, Vinyl
Foundation	Concrete Perimeter

### Additional Information

Date Listed	March 27th, 2025
Days on Market	11
Zoning	Zone 91

DATA IS DEEMED RELIABLE BUT IS NOT GUARANTEED ACCURATE BY THE REALTORS® ASSOCIATION OF EDMONTON. COPYRIGHT 2025 BY THE REALTORS® ASSOCIATION OF EDMONTON. ALL RIGHTS RESERVED. Trademarks are owned or controlled by the Canadian Real Estate Association (CREA) and identify real estate professionals who are members of CREA (REALTOR®, REALTORS®) and/or the quality of services they provide (MLS®, Multiple Listing Service®)

Listing information last updated on April 7th, 2025 at 6:47pm MDT